

Westphalia Telephone Company
M.P.S.C. No. 1R

Original Sheet No. 1

WESTPHALIA TELEPHONE COMPANY

Schedule of Rates, Charges, and
Regulations governing

Local Telephone Exchange Service

Applying in the Exchanges of this Company
in Michigan as designated in the Table of
Contents herein.



Issued: March 10, 1993
By: Dave Fox, Manager

Effective: March 22, 1993
Westphalia, Michigan

LOCAL TELEPHONE EXCHANGE SERVICE

TABLE OF CONTENTS

Title Page	Sheet 1
Table of Contents	Sheet 2
Checklist	Sheet 3
Subject Index	Sheet 4
Application and Arrangement of Tariff	Sheet 5
Index of Exchanges	Sheet 6
Basic Local Service	Sheet 7 - 7.1
Written Description of Exchange Area	Sheet 8 - 8.1
Exchange Area Map	Sheet 9
Application of Boundary Designations	Sheet 10
Service Charges	Sheet 11 - 11.3
Held For Future Use	Sheet 12 - 12.2
Lifeline Service	Sheet 13 - 13.3
Combination Main Station Service	Sheet 14
Joint User Service	Sheet 15 - 15.1
Paystation Service	Sheet 16 - 16.2
Centrex Service	Sheet 17 - 17.4

Issued: January 27, 2004

Effective: January 28, 2004

By: Dave Fox, Manager

Westphalia, Michigan

LOCAL TELEPHONE EXCHANGE SERVICE

CHECKLIST

Original Sheet No. 1	Issued March 10, 1993
3 rd Revised Sheet No. 2	Issued January 27, 2004
11 th Revised Sheet No. 3	Issued June 7, 2019*
2 nd Revised Sheet No. 4	Issued January 27, 2004
Original Sheet No. 5	Issued March 10, 1993
Original Sheet No. 6	Issued March 10, 1993
5 th revised Sheet No. 7	Issued October 3, 2007
Original Sheet No. 7.1	Issued January 27, 2004
Original Sheet No. 8	Issued March 10, 1993
Original Sheet No. 8.1	Issued March 10, 1993
Original Sheet No. 9	Issued March 10, 1993
Original Sheet No. 10	Issued March 10, 1993
Original Sheet No. 11	Issued March 10, 1993
Original Sheet No. 11.1	Issued March 10, 1993
Original Sheet No. 11.2	Issued March 10, 1993
Original Sheet No. 11.3	Issued March 10, 1993
1 st Revised Sheet No. 12	Issued June 30, 1997
1 st Revised Sheet No. 12.1	Issued June 30, 1997
1 st Revised Sheet No. 12.2	Issued June 30, 1997
5 th Revised Sheet No. 13	Issued June 7, 2019*
6 th Revised Sheet No. 13.1	Issued June 7, 2019*
4 th Revised Sheet No. 13.2	Issued June 7, 2019*
1 st Revised Sheet No. 13.3	Issued March 30, 2012
Original Sheet No. 14	Issued March 10, 1993
Original Sheet No. 15	Issued March 10, 1993
Original Sheet No. 15.1	Issued March 10, 1993
1 st Revised Sheet No. 16	Issued June 30, 1997
1 st Revised Sheet No. 16.1	Issued June 30, 1997
Original Sheet No. 16.2	Issued June 30, 1997
Original Sheet No. 17	Issued February 3, 1995
2 nd Revised Sheet No. 17.1	Issued January 27, 2004
1 st Revised Sheet No. 17.1.1	Issued January 27, 2004
Original Sheet No. 17.1.1.5	Issued January 27, 2004
Original Sheet No. 17.1.2	Issued June 30, 2001
First revised Sheet No. 17.2	Issued June 30, 2001
Original Sheet No. 17.3	Issued February 3, 1995
Original Sheet No. 17.4	Issued February 3, 1995

* New or revised sheet

Issued: June 7, 2019

Effective: June 11, 2019

Issued under the authority of Public Act 179 of 1991 as amended.

By: Mike Fitzpatrick, Manager, Westphalia Telephone Company, PO Box 368, Westphalia, MI 48894,
989-587-5000, admin@4wbi.net

LOCAL TELEPHONE EXCHANGE SERVICE

SUBJECT INDEX

Application and Arrangement of Tariff	5
Application of Boundary Designations	10
Basic Local Service	7-7.1
Centrex Service	17-17.4
Checklist	3
Combination Main Station Service	14
Exchange Area Map	9
Held for Future Use	12-12.2
Index of Exchanges	6
Joint User Service	15-15.1
Lifeline Service	13-13.2
Paystation Service.	16-16.2
Service Charges	11-11.3
Subject Index	4
Table of Contents	2
Title Page	1
Written Description of Exchange Area	8-8.1

LOCAL TELEPHONE EXCHANGE SERVICE
APPLICATION AND ARRANGEMENT OF TARIFF

APPLICATION

1. This Tariff applies to Local Telephone Exchange Services of Westphalia Telephone Company - hereinafter referred to as the Telephone Company - in exchanges in Michigan as designated herein.
2. Local Telephone Exchange Service is that of furnishing facilities for telephone intercommunication between customers within a Local Service Area.
3. The provision of service is subject to regulations specified in the M.P.S.C. Tariffs of the Telephone Company, which tariffs as they now exist or as they may be revised, added to, or supplemented by superseding issues are hereby made a part of this Tariff.

EXPLANATION OF SYMBOLS

- (C) Signifies a changed regulation.
- (D) Signifies a discontinued rate, treatment or regulation.
- (I) Signifies an increased rate, or new treatment resulting in increased rate.
- (N) Signifies a new rate, treatment or regulation.
- (R) Signifies a reduced rate, or new treatment resulting in a reduced rate.



Issued: March 10, 1993
By: Dave Fox, Manager

Effective: March 22, 1993
Westphalia, Michigan

Issued under authority of the Michigan Public Service Commission Order dated December 22, 1992, Case No. U-10064.

LOCAL TELEPHONE EXCHANGE SERVICE
INDEX OF EXCHANGES SHOWING INCORPORATED
VILLAGES, TOWNSHIPS AND COUNTIES WITHIN
ITS EXCHANGE SERVICE AREA

<u>Exchange</u>	<u>Incorporated Village</u>	<u>Townships</u>	<u>County</u>
Westphalia	Westphalia	Dallas Riley Westphalia Eagle	Clinton
		Portland Lyons	Ionia



Issued: March 10, 1993
By: Dave Fox, Manager

Effective: March 22, 1993
Westphalia, Michigan

Issued under authority of the Michigan Public Service Commission Order dated December 22, 1992, Case No. U-10064.

LOCAL TELEPHONE EXCHANGE SERVICE
BASIC LOCAL SERVICE

Exchange: WESTPHALIA

A. GENERAL

1. The provision of service at the rates shown below is subject to the regulations given in the General Rules and Regulations as they now exist and are filed with and form part of this Tariff.
2. The rates shown below entitle the customer all stations bearing the designation of a central office at the following exchanges, which comprise the Local Service Area.

WESTPHALIA DEWITT FOWLER-PEWAMO GRAND LEDGE PORTLAND
ST. JOHNS MUIR

The Company will block 1-plus dialed calls to stations within the Local Service Area.

3. Calls made to a telephone number with an NPA NXX that is associated with the rate center that is within the customer's local calling area are local calls regardless of the physical location of the called party.

B. BASIC SERVICE RATES, MONTHLY RATES

1. Access Line Charge, Per Line, Per Month

Class of Service

Business:

MultiLine (6 or fewer lines)	\$ 29.17 ⁽¹⁾
Multi-Line (7 or more lines)	27.21 ⁽²⁾
One-Party	24.71 ⁽³⁾

Residence:

One-Party	\$ 22.82 ⁽⁴⁾
-----------	-------------------------

- (1) The rates effective as of May 1, 2000 were as follows (i) basic service charge including Touchtone, of \$18.69, (ii) End User common Line (EUCL) charge of \$3.50, and (iii) dialing parity charge of \$0.00.
- (2) The rates effective as of May 1, 2000 were as follows (i) basic service charge including Touchtone, \$18.69, (ii) EUCL charge of \$1.00, and (iii) dialing parity charge of \$0.00.
- (3) The rates effective as of May 1, 2000 were as follows (i) basic service charge including Touchtone, of \$13.69, (ii) EUCL charge of \$3.50, and (iii) dialing parity charge of \$0.00.
- (4) The rates effective as of May 1, 2000 were as follows (i) basic service charge including Touchtone, of \$13.05, (ii) EUCL charge of \$3.50, and (iii) dialing parity charge of \$0.00.

Issued: October 3, 2007

Effective: October 6, 2007

Issued under authority of Public Act 179 of 1991 as amended

David Fox, President
PO Box 368
Westphalia, MI 48894-0368

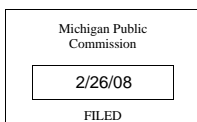

LOCAL TELEPHONE EXCHANGE SERVICE

BASIC LOCAL SERVICE

Exchange: WESTPHALIA

C. LOCAL MOU RATE

For calls dialed to a station bearing the designation of a central office within the Westphalia exchange, the Company will charge the following:

First 2,000 Conversation MOU in each billing period	\$0.00 per MOU
Each Conversation MOU over 2000 in that billing period	\$0.00 per MOU

For calls dialed to a station bearing the designation of a central office within the DeWitt, Fowler-Pewamo, Grand Ledge, Portland, St.Johns or Muir exchanges, the Company will charge the following:

First 2,000 Conversation MOU in each billing period	\$0.00 per MOU
Each Conversation MOU over 2000 in that billing period	\$0.04 per MOU

The Company will measure Conversation MOU from the time when the Company's switching equipment receives answer supervision to the earlier of when the Company's switch receives disconnection supervision from the Westphalia switch or from the terminating switch.

The Company will measure Conversation MOU to the next higher whole MOU per call.

The Company will not bill the end user for non-conversation time related to local calls.

Conversation MOU do not include 0-plus or 0-minus calls.

The Company will not provide call record detail for local usage.

No MOU are carried forward from month to month.

Issued: January 27, 2004

Effective: January 28, 2004

Issued under the authority of Public Act 179 of 1991 as amended.

By: Dave Fox, Manager

Westphalia, Michigan



LOCAL TELEPHONE EXCHANGE SERVICE

WRITTEN DESCRIPTION OF EXCHANGE AREA

Exchange: WESTPHALIA

1. BASE RATE AREA - Which is that area described as follows:

The rectangular area comprised of the Southwest 1/4 of Section 4, Southeast 1/4 of Section 5, Northeast 1/4 of Section 8, and Northwest 1/4 of Section 9, Westphalia Township, Clinton County.

2. EXCHANGE SERVICE AREA - Which is that area described as follows:

Commencing at the west 1/8 post of the southwest 1/4 of Section 20, Dallas Township, T6N, R4W, Clinton County; thence south along Jones Road to Taft Road; thence west along Taft Road to the Ionia/Clinton County Line; thence south along that line to the east 1/4 post of Section 36, Lyons Township, T6N, R4W, Ionia County; thence west on a line parallel to Maple Road to Divine Highway; thence south along Divine Highway to Maple Road; thence east along Maple Road to the northwest corner of Section 2, Portland Township, T6N, R4W, Ionia County; thence south along the west line of Section 2 to the east 1/8 post of the southeast 1/4 of Section 3; thence west along a line parallel to David Highway to Divine Highway; thence south along Divine Highway to David Highway; thence east along David Highway to the north 1/4 post of Section 11; thence south along a line parallel to Spaulding Road to the center of Section 14; thence east along a line parallel to MarSalle Road to the Ionia/Clinton County Line; thence south along that line to the southwest corner of Section 19, Westphalia Township, T5N, R4W, Clinton County; thence east along Lehman Road to Jones Road; thence south along Jones Road to Cutler Road; thence east along Cutler Road to the north 1/4 post of Section 5, Eagle Township, T5N, R4W, Clinton County; thence south 1/4 mile to the west 1/8 post of the northeast corner of Section 5; thence east to the east 1/8 post of the northwest corner of Section 3; thence north to the center of Section 27, Westphalia Township, T5N, R3W, Clinton County; thence east to the center of Section 26; thence north to the north 1/4 post of Section 26; thence east to Bauer Road; thence north along Bauer Road to a point 1/10 mile north of Lehman Road; thence east on a line 1/10 mile north of Lehman Road to a point 1/10 mile east of Bauer Road; thence north along a line parallel to and 1/10 mile east of Bauer Road to a point 1/10 mile north of Pratt Road; thence east along a line parallel to and 1/10 mile north of Pratt Road to Dexter Trail; thence north along Dexter Trail to the north 1/8 post of the southeast 1/4 of Section 18, Riley Township, T6N, R3W, Clinton County; thence east to Forest Hill Road; thence north along Forest Hill Road to Jason Road; thence west

Issued: March 10, 1993
By: Dave Fox, Manager

Effective: March 22, 1993
Westphalia, Michigan

LOCAL TELEPHONE EXCHANGE SERVICE

WRITTEN DESCRIPTION OF EXCHANGE AREA

2. EXCHANGE SERVICE AREA (Cont'd)

along Jason Road to Dexter Trail; thence north along Dexter Trail to Price Road; thence west along Price Road to Bauer Road; thence north along Bauer Road to Dexter Trail; thence northwesterly along Dexter Trail to a point 1/10 mile south of the east-west 1/4 line of Section 26, Dallas Township, T6N, R3W, Clinton County; thence west to a point 1/10 mile west and 1/10 mile south of the center of Section 27; thence north to the east-west 1/8 line of the southwest 1/4 of Section 22; thence west to the point of beginning.



Issued: March 10, 1993
By: Dave Fox, Manager

Effective: March 22, 1993
Westphalia, Michigan

Issued under authority of the Michigan Public Service Commission Order dated December 22, 1992, Case No. U-10064.

LOCAL TELEPHONE EXCHANGE SERVICE

EXCHANGE AREA MAP

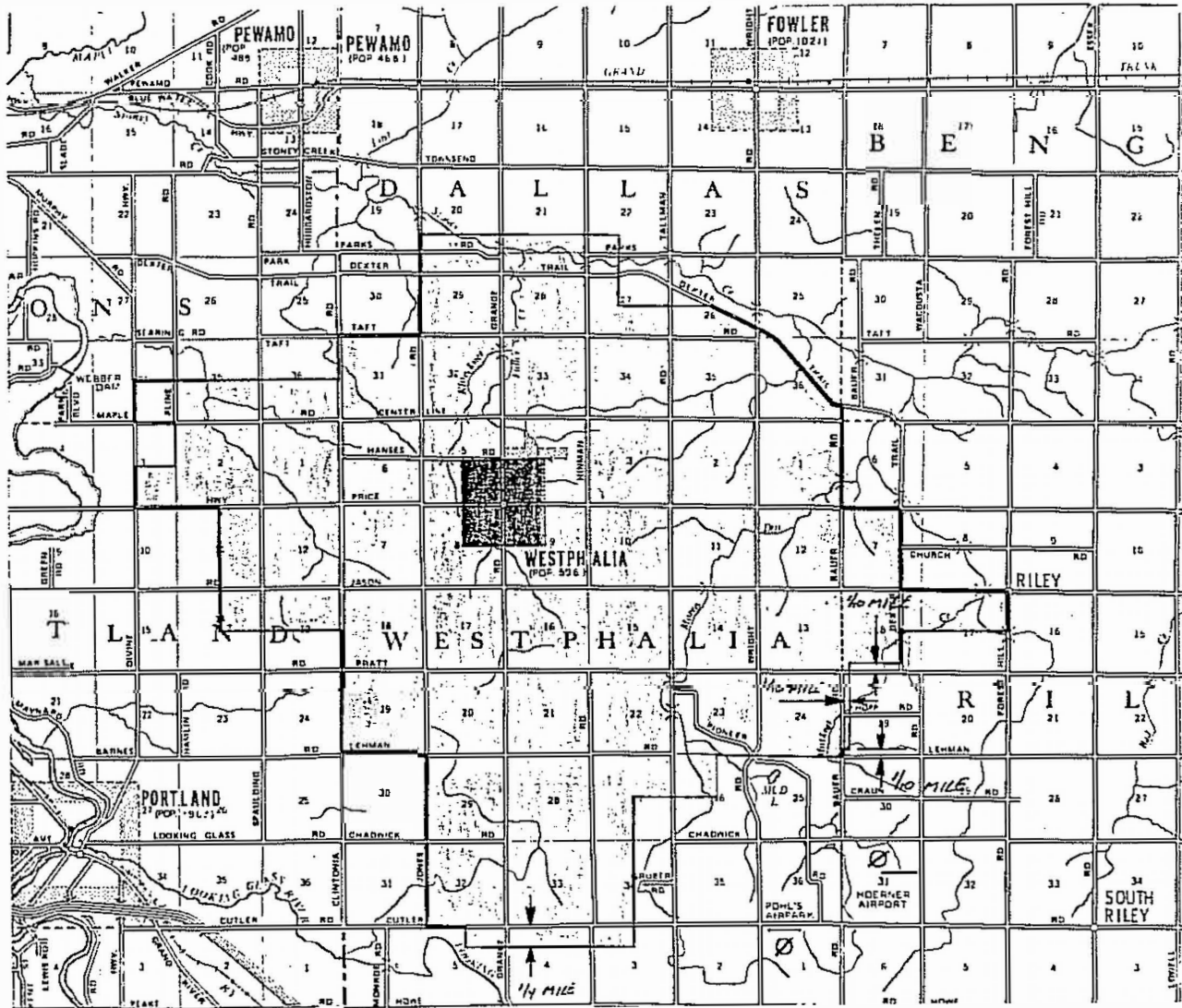

Issued: March 10, 1993
By: Dave Fox, Manager

Effective: March 22, 1993
Westphalia, Michigan

Issued under authority of the Michigan Public Service Commission Order dated December 22, 1992, Case No. U-10064.

LOCAL TELEPHONE EXCHANGE SERVICE
APPLICATION OF BOUNDARY DESIGNATIONS



A. GENERAL

1. Application of Boundary Designations
 - a. Boundaries for Locality Rate Areas and the service areas for Exchanges are designated on maps in Tariff M.P.S.C. No. 1R.
 - b. Each establishment is within only one Exchange area except as provided in c. below.
 - c. Where the boundary is designated as a road (street or highway) the area includes that side of the highway on which are located the general plant facilities serving both sides of the highway. When such facilities are located on the near side of the highway, a customer located on the opposite side is considered to be within the area if he can be served by a drop wire using not more than one additional pole; when the general facilities are located on the far side of the boundary, a customer on that side is considered to be within the area if he can be served by means of a drop wire not requiring any additional poles.
 - d. Where the boundary is designated as the center of the road (street or highway), each side of the road is in a different service area.
 - e. Where the boundary is designated as a river (stream) or railroad, each side of the river or railroad is in a different service area.
 - f. Where the boundary divides a lake, the shore of the lake is in different service areas in accordance with the boundary designation at the shore line.
 - g. Where the boundary is designated as a Township Section Line or a specified distance from a Township Section Line, customers are served in accordance with their location with respect to such boundary line. When such a line is other than the section line or one-quarter or one-half mile from a section line, the location of the boundary line with respect to the section line will be shown in feet or fractional miles on the Exchange Area Map Sheet.

Issued: March 10, 1993
By: Dave Fox, Manager

Effective: March 22, 1993
Westphalia, Michigan

Issued under authority of the Michigan Public Service Commission Order dated December 22, 1992, Case No. U-10064.

LOCAL TELEPHONE EXCHANGE SERVICES
SERVICE CHARGES



A. GENERAL

1. a. The Service Charges covered herein are applicable in connection with the establishment of regulated telephone service and subsequent moves, changes and additions of lines, or other regulated services.
2. Service Charges
 - a. The Service Ordering Charge is the charge for work performed by the Telephone Company in connection with the receiving, recording and processing of customer requests for service to be performed or provided at the same time, on the same system and on the same premises. The term "per order" means all work or service ordered at the same time for the same account.
 - b. The Line Connection Charge applies to each central office line (exchange line, trunks, etc.) for work required in the central office and outside plant, including restoral of service after temporary disconnection of service for nonpayment.
 - c. The Premises Visit Charges shall apply for those visits to the customer's premises by company personnel which are necessary because of the customer's service request.
3. Customer Premises
 - a. A premises is a building, portion of a building or buildings on the same continuous property occupied by the customer in the conduct of his business or occupied by the customer as a residence. All space for offices occupied by a customer on the same or separate floors of one building are considered as a single (or same) premises.
 - (1) Same continuous property shall mean an uninterrupted plot of land within the same block and occupied by one customer. Same block is defined as parcel of land enclosed but uncrossed by public thoroughfares. Railroad tracks, rivers and alleys are not considered as public thoroughfares.

Issued: March 10, 1993
By: Dave Fox, Manager

Effective: March 22, 1993
Westphalia, Michigan

LOCAL TELEPHONE EXCHANGE SERVICES
SERVICE CHARGES



A. GENERAL (Cont'd)

3. Customer Premises (Cont'd)

(2) A building shall mean a structure on one foundation or two structures on separate foundations with a common wall or abutting walls with ready access from one structure to the other by means of doorways or permanent openings through the intervening wall or walls. Structures in the same or different block occupied by one customer and connected by passageways shall be considered as the same building if the passageway is actually used as a continuation of the space in the two buildings and not principally used as a walkway.

4. Additional Conditions

- a. Services charges are in addition to all other applicable rates and charges associated with the service being provided. Installation charges for additional equipment as shown in Tariff M.P.S.C. No. 2(R) may apply.
- b. The charges specified herein do not contemplate work being performed by the Company employees at a time when overtime wages apply due to the request of the customer nor do they contemplate work begun being interrupted by the customer. If the customer requests overtime labor being performed or interrupts work once begun, a charge in addition to the specified charges will be made equal to the additional cost involved.
- c. No service charges apply for a change in service or move of equipment if made on the initiative of the Telephone Company for maintenance reasons or because of a change in the type of central office operation or for other Company reasons.
- d. No duplication of charges is made when, owing to the lack of standard equipment specified in a customer's order, installation of other standard equipment is made temporarily in order to provide service.

Issued: March 10, 1993
By: Dave Fox, Manager

Effective: March 22, 1993
Westphalia, Michigan

LOCAL TELEPHONE EXCHANGE SERVICES

SERVICE CHARGES

A. GENERAL (Continued)

4. Additional Conditions (Cont'd)

e. No service charges apply for any changes in equipment required because of a change in class of basic service.

5. Restoral of Service

a. Service discontinued by the Telephone Company because of non-payment when the services has not been disconnected is subject to the Restoral of Service Charge.

b. When service is rendered inoperative by fire or other causes beyond the control of the customer which render the premises unfit for occupancy, the same service or type of equipment as destroyed will be reestablished at the same or different location, at the option of the customer, without Service or Installation Charge.

B. SERVICE CHARGES

1. Service Ordering Charge

a. Initial Service Order, per order

Applies to any new customer's service order \$ 14.00

b. Subsequent Service Order, per order

Applies to any present customer's order to relocate, install, change or add to the service; telephone number change; restoral of service after disconnect for nonpayment; additional central office lines, et cetera. 6.00

2. Line Connection Charge

Per Line 10.00



Issued: March 10, 1993
By: Dave Fox, Manager

Effective: March 22, 1993
Westphalia, Michigan

LOCAL TELEPHONE EXCHANGE SERVICES

SERVICE CHARGES

B. SERVICE CHARGES (Cont'd)

3. Premises Visit Charge

Applies to any service order requiring a premise visit for the above items. Does not apply for premise visit required solely to remove or disconnect customer disconnected items or service, change or modify equipment for company reasons.

10.00



Issued: March 10, 1993
By: Dave Fox, Manager

Effective: March 22, 1993
Westphalia, Michigan

Issued under authority of the Michigan Public Service Commission Order dated December 22, 1992, Case No. U-10064.

Westphalia Telephone Company
M.P.S.C. No. 1R

1st Revised Sheet No. 12
Cancels Original Sheet No. 12

LOCAL TELEPHONE EXCHANGE SERVICE
HELD FOR FUTURE USE



Issued: June 30, 1997
By: Dave Fox, Manager

Effective: May 19, 1997
Westphalia, Michigan

Issued under authority of the Michigan Public Service Commission Order dated December 22, 1992, in Case No. U-10064.

Westphalia Telephone Company
M.P.S.C. No. 1R

1st Revised Sheet No. 12.1
Cancels Original Sheet No. 12.1

LOCAL TELEPHONE EXCHANGE SERVICE
HELD FOR FUTURE USE



Issued: June 30, 1997
By: Dave Fox, Manager

Effective: May 19, 1997
Westphalia, Michigan

Issued under authority of the Michigan Public Service Commission Order dated December 22, 1992, in Case No. U-10064.

Westphalia Telephone Company
M.P.S.C. No. 1R

1st Revised Sheet No. 12.2
Cancels Original Sheet No. 12.2

LOCAL TELEPHONE EXCHANGE SERVICE
HELD FOR FUTURE USE



Issued: June 30, 1997
By: Dave Fox, Manager

Effective: May 19, 1997
Westphalia, Michigan

Issued under authority of the Michigan Public Service Commission Order dated December 22, 1992, in Case No. U-10064.

LOCAL TELEPHONE EXCHANGE SERVICE
LIFELINE SERVICE

A. DESCRIPTION

The descriptions, Lifeline program eligibility requirements, discounts and regulations under the State and Federal Lifeline Programs for low income consumers are set forth in Telecommunications Association of Michigan Tariff M.P.S.C. No. 9R in which the Company is a concurring carrier.

(C)

(D)

(D)

LOCAL TELEPHONE EXCHANGE SERVICE
LIFELINE SERVICE

B. REGULATIONS

(D)

(D)

LOCAL TELEPHONE EXCHANGE SERVICE
LIFELINE SERVICE

C. MONTHLY RATES AND DISCOUNTS FOR LIFELINE CUSTOMERS

(D)

D. MONTHLY RATE FOR NON LIFELINE CUSTOMERS

(D)

(D)

(D)

Westphalia Telephone Company
MPSC No. 1R

1st Revised Sheet No. 13.3
Cancels Original Sheet No. 13.3

LOCAL TELEPHONE EXCHANGE SERVICE

LIFELINE SERVICE

Issued: March 30, 2012

Effective: April 1, 2012

Issued under the authority of the PA 179, Michigan Telecommunications Act, as amended.

Dave Fox, Manager, Westphalia Telephone Company, PO Box 368, Westphalia, MI 48894, 989-587-5000, admin@4wbi.net

LOCAL TELEPHONE EXCHANGE SERVICE

COMBINATION MAIN STATION SERVICE

A. GENERAL

1. Combination Main Station Service applies to cases where a customer wishes to contract for a main station service at each of two separate locations (ordinarily each station will be assigned a separate telephone number) within the same exchange, so as to be able to answer calls for one main station at the other main station location or both stations at either location.
2. Combination Main Station Service is provided only in connection with individual lines (excluding coin box lines and lines terminating in key telephone systems, key equipment, key cabinets, and similar switching devices) and is furnished subject to the ability of the Telephone Company to provide satisfactory transmission and signaling arrangements and to the rate treatment outlined herein.
3. Combination Main Station Service may be employed where one station is at a business location and the other at a residence or where both stations are at either business or residence locations, but only in connection with services contracted for and used by the same customer.

B. RATES

1. Each main station is charged for at the established individual line business or residence rate, according to the classification of the service at each premises as to business or residence character.



Issued: March 10, 1993
By: Dave Fox, Manager

Effective: March 22, 1993
Westphalia, Michigan

Issued under authority of the Michigan Public Service Commission Order dated December 22, 1992, Case No. U-10064.

LOCAL TELEPHONE EXCHANGE SERVICE

JOINT USER SERVICE

A. GENERAL

1. Joint User Service is an arrangement whereby a person or firm-designated a Joint User - is permitted to use the service of a customer. To facilitate this use, a directory listing is provided for each Joint User.
2. Joint User Service is provided only in connection with individual line business service and private branch exchange business service.
3. The Joint User must be located in the same office or suite of offices as the customer, or in an office immediately adjacent thereto and connected therewith by passageways other than public passageways.
4. Joint User Service is not furnished in association with the service of a customer who is engaged primarily in performing service of a secretarial nature or who is in the business of renting space to transient or permanent tenants.
5. No separate ring numbers of distinctive designations are assigned for the purpose of signaling Joint Users.
6. Joint User Service must be contracted for by the original customer who is required to assume responsibility for all charges incurred by the Joint User.
7. Charges for Joint User Service date from the day the service is first rendered. The Joint User Service is automatically discontinued upon termination of the main service. The minimum charge for Joint User Service, however, is the charge for the period of one month.



Issued: March 10, 1993
By: Dave Fox, Manager

Effective: March 22, 1993
Westphalia, Michigan

LOCAL TELEPHONE EXCHANGE SERVICE

JOINT USER SERVICE

A. GENERAL (Cont'd)

8. After the listing of a Joint User has been inserted in the directory, such Joint User Service shall not be discontinued during the life of the directory - but not to exceed one year, unless:
 - a. The main station service is also discontinued.
 - b. The Joint User moves from the premises in which the main station is located.
 - c. The Joint User establishes main station service on the same premises.

B. RATES

Joint User Service, including one listing in the directory, is furnished at 1/2 the charge for one Individual Business Line, per month.



Issued: March 10, 1993
By: Dave Fox, Manager

Effective: March 22, 1993
Westphalia, Michigan

Issued under authority of the Michigan Public Service Commission Order dated December 22, 1992, Case No. U-10064.



LOCAL TELEPHONE EXCHANGE SERVICE
PAYSTATION SERVICE

A. GENERAL

Paystation Service provides telephone service to a customer-leased or owned paystation with or without coin collecting devices. A Paystation Access Line permits providers of such service to provide pay telephone service to the public.

B. DEFINITIONS

Coin Supervision - Provides signaling capability from the central office for paystations that do not have a signaling capability within the telephone. This signaling capability provides operators and/or operator systems coin control.

Customer - For the purposes of this tariff, the customer is the Paystation Service Provider.

Network Interface Device - A company-provided jack or its equivalent. It is the point of connection between the Company owned wiring and wiring owned by the customer. For the purposes of this tariff, the network interface device will be installed at a location mutually agreed upon by the customer and the Company.

Originating Line Screening (OLS) - Enables operator service providers to determine whether there are billing restrictions on the exchange access line from which a call originates. OLS service delivers codes on operator assisted calls to identify calls originating from privately owned paystations, inmate locations, and hotels/motels, etc. Rates for this service are found in the appropriate interstate access tariff, when facilities and service are available.

Paystation Access Line - A basic coin transmission dial tone line. It is a line side connection from the local exchange switch to the point of demarcation at the customer premises.

Selective Class of Call Screening - Enables the customer to restrict outgoing operator-handled calls, placed over the Company's network, from the service point to only those calls which are charged to a called telephone, a third party or a calling card. Selective Class of Call Screening will be provided at the customer's option, where such facilities are available.

Issued: June 30, 1997
By: Dave Fox, Manager

Effective: May 19, 1997
Westphalia, Michigan

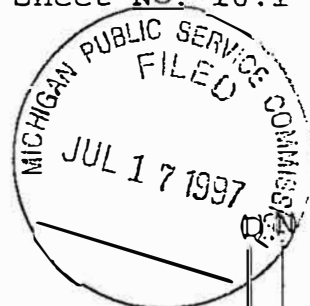

LOCAL TELEPHONE EXCHANGE SERVICE
PAYSTATION SERVICE

C. RULES AND REGULATIONS

1. Paystation Service will be considered a business Service for the purpose of applying the terms, rates and conditions found elsewhere in this tariff.
2. Only one paystation instrument may be connected to each Paystation Access Line. Off-Premise Extensions are not permitted.
3. The customer shall be responsible for the installation, operation and maintenance of any paystation instrument used in connection with this service.
4. Requests to Directory Assistance Service originated from paystations will be charged the applicable rate of the Directory Assistance Service Provider.
5. Directory listings may be provided under the regulations that govern the furnishing of listings for business customers.
6. Coin-free operator and emergency 911 access must be available from all paystations.
7. One directory will be distributed to the customer without charge for each paystation business exchange line.
8. The customer is responsible for the provision of booths, shelves, directories and all other ancillary equipment.
9. The customer shall be responsible for the payment of charges for all local and toll messages originating from or accepted at this type of service, including any Directory Assistance Calls. The Company shall not be liable for shortages of coins collected and deposited at the customer's paystation instrument.
10. The Company reserves the right to disconnect service when the customer does not comply with the F.C.C. and state rules and regulations related to paystation service and equipment.

Issued: June 30, 1997
By: Dave Fox, Manager

Effective: May 19, 1997
Westphalia, Michigan

Issued under authority of the Michigan Public Service Commission Order dated December 22, 1992, in Case No. U-10064.

DN



LOCAL TELEPHONE EXCHANGE SERVICE
PAYSTATION SERVICE

C. RULES AND REGULATIONS (Continued)

11. The multiline Business Subscriber Line Charge, found in the interstate and intrastate access tariff, is applicable to all paystation access lines.
12. All Company owned paystations will comply with Rules, Regulations and Rates outlined in this Paystation Service Tariff.

D. RATES AND CHARGES

	<u>Monthly Rate</u>
1. Paystation Access Line*	Business One-Party local rate shall apply
2. Coin Supervision	\$2.21
	<u>Coin Rate**</u>
3. Each outgoing local message	\$0.25

* No measured service rates apply. Installation, move and change charges will be those applicable to business service.

** This rate is not regulated by the Commission.

Issued: June 30, 1997
By: Dave Fox, Manager

Effective: May 19, 1997
Westphalia, Michigan

Issued under authority of the Michigan Public Service Commission Order dated December 22, 1992, in Case No. U-10064.

LOCAL TELEPHONE EXCHANGE SERVICE
CENTREX SERVICE

A. General

1. Centrex Service is a central office-based, flat rate, communication service which provides capabilities similar to those offered on a Private Branch Exchange, but without requiring switching equipment on the customer's premises. Centrex integrates all customer lines into a single telecommunications system.
2. Centrex Service is a local exchange telecommunications service provided from a suitably equipped telephone company central office with available outside plant.
3. Centrex permits the direct dialing between lines connected to the service and the direct dialing of outgoing calls. Incoming calls are received by direct inward dialing from the calling party to the station line or through an attendant console.
4. The Centrex station lines includes a local loop (which includes dial tone and a telephone number) and the unregulated basic features package. Unregulated optional features and services are available.
5. Centrex is offered only as a complete service. The local loop is not provided without unregulated basic features or vice versa.



ISSUED: February 3, 1995

EFFECTIVE: February 7, 1995

Issued under the authority of the
Michigan Telecommunications Act, 1991 PA 179.

By: David A. Fox, General Manager

Westphalia, Michigan

LOCAL TELEPHONE EXCHANGE SERVICE

CENTREX SERVICE

B. RATES AND CHARGES - BUSINESS

1. The following per line Centrex rates and charges apply for contract periods ranging from month-to-month to 36 months. The customer is required to pay for the number of Company-provided Centrex lines in each tier at the rate for the service period selected:

Centrex Rates - Month-to-Month, Per Line:

<u>Number of Lines</u>	<u>Monthly Rate</u>
2 - 4	\$ 26.06 ⁽¹⁾
5 - 6	24.56 ⁽²⁾
7	22.06 ⁽³⁾
8 - 10	20.55 ⁽⁴⁾
Over 10	18.30 ⁽⁵⁾

- (1) The rates in effect as of May 1, 2000 were as follows (i) basic service charge including Touchtone, of \$15.04, (ii) state End User Common Line (EUCL) charge of \$3.50, and (iii) dialing parity charge of \$0.00.
- (2) The rates in effect as of May 1, 2000 were as follows (i) basic service charge including Touchtone, of \$13.54, (ii) state EUCL charge of \$3.50, and (iii) dialing parity charge of \$0.00.
- (3) The rates in effect as of May 1, 2000 were as follows (i) basic service charge including Touchtone, of \$13.54, (ii) state EUCL charge of \$1.00, and (iii) dialing parity charge of \$0.00.
- (4) The rates in effect as of May 1, 2000 were as follows (i) basic service charge including Touchtone, of \$12.03, (ii) state EUCL charge of \$1.00, and (iii) dialing parity charge of \$0.00.
- (5) The rates in effect as of May 1, 2000 were as follows (i) basic service charge including Touchtone, of \$9.78, (ii) state EUCL charge of \$1.00, and (iii) dialing parity charge of \$0.00.

Issued: January 27, 2004

Effective: January 28, 2004

Issued under authority of Public Act 179 of 1991, as amended.

By: Dave Fox, Manager

Westphalia, Michigan

Westphalia Telephone Company
M.P.S.C. No. 1R

1st Revised Sheet No. 17.1.1
Cancels Original Sheet No. 17.1.1

LOCAL TELEPHONE EXCHANGE SERVICE

CENTREX SERVICE

Issued: January 27, 2004

Effective: January 28, 2004

Issued under the authority of Public Act 179 of 1991 as amended.

By: Dave Fox, Manager

Westphalia, Michigan

LOCAL TELEPHONE EXCHANGE SERVICE

CENTREX SERVICE

B. RATES AND CHARGES - BUSINESS (Continued)

2. LOCAL MOU RATE

For calls dialed to a station bearing the designation of a central office within the Westphalia exchange, the Company will charge the following:

First 2,000 Conversation MOU times lines in Centrex Group in each billing period
\$0.00 per MOU

Each Conversation MOU over above in that billing period
\$0.00 per MOU

For calls dialed to a station bearing the designation of a central office within the DeWitt, Fowler-Pewamo, Grand Ledge, Portland, St. Johns or Muir exchanges, the Company will charge the following:

First 2,000 Conversation MOU times lines in Centrex Group in each billing period
\$0.00 per MOU

Each Conversation MOU over above in that billing period
\$0.04 per MOU

The Company will measure Conversation MOU from the time when the Company's switching equipment receives answer supervision to the earlier of when the Company's switch receives disconnection supervision from the Westphalia switch or from the terminating switch.

The Company will measure Conversation MOU to the next higher whole MOU per call.

The Company will not bill the end user for non-conversation time related to local calls.

Conversation MOUs do not include 0-plus or 0-minus calls.

The Company not provide call record detail for local usage.

No MOU are carried forward from month to month.

Issued: January 27, 2004

Effective: January 28, 2004

Issued under the authority of Public Act 179 of 1991 as amended.

By: Dave Fox, Manager

Westphalia, Michigan

LOCAL TELEPHONE EXCHANGE SERVICE

CENTREX SERVICE

B. RATES AND CHARGES (Continued)

1. The following per line Centrex rates and charges apply for contract periods ranging from month-to-month to 36 months. The customer is required to pay for the number of Company-provided Centrex lines in each tier at the rate for the service period selected:
(continued)

Service Establishment Charges

	<u>Non-Recurring Charges</u>
Per System	\$ 50.00
Per Line	10.00

2. The above rates and non-recurring charges are in addition to the applicable service ordering charges as provided in M.P.S.C. No. 1R of this tariff.
3. The station line is provided as a complete service. Neither the local loop portion, nor the unregulated basic features package will be provided as a separate entity.



Issued: June 30, 2001

Effective: July 10, 2001

Issued under authority of the Michigan Telecommunications Act, 1991 PA 179, as amended.

By: Dave Fox, Manager

Westphalia, Michigan

LOCAL TELEPHONE EXCHANGE SERVICE

CENTREX SERVICE

B. RATES AND CHARGES (Cont'd)

4. Centrex lines that terminate in key system common equipment or other CPE that performs pooling or switching functions must be provided in a "squared" arrangement in order to retain Centrex tariff rates. A "squared" arrangement is one in which the number of Centrex lines equals the number of stations/lines served by the key system common equipment or the CPE switching/pooling equipment. If the number of stations serviced by the key system common equipment or the CPE switching/pooling equipment exceeds the number of Centrex lines, the Centrex lines will be rated at the appropriate Key Trunk or PBX Trunk rates as found in Tariff M.P.S.C. No. 1R of this tariff.

5. Federal End User Common Line Charge (EUCL)

The Federal End User Common Line Charge (EUCL) will be assessed based upon the total number of Centrex lines to which the customer subscribes.

C. REGULATIONS AND CONDITIONS

1. A Centrex Customer must have a minimum of two (2) Centrex lines.
2. The minimum charge period for services provided under this tariff shall be for one (1) month.
3. Centrex is offered subject to the availability of outside plant and/or Central Office facilities.
4. One (1) directory listing is provided without charge for each Centrex customer. Additional listings will be assessed the standard tariff charge.
5. Each Centrex customer is provided five (5) Directory Assistance calls per month without charge. Additional calls will be assessed the standard tariff charge.

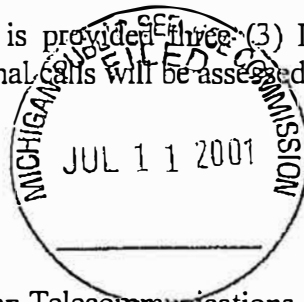

Issued: June 30, 2001

Effective: July 10, 2001

Issued under authority of the Michigan Telecommunications Act, 1991 PA 179, as amended.

By: Dave Fox, Manager

Westphalia, Michigan

LOCAL TELEPHONE EXCHANGE SERVICE
CENTREX SERVICE

C. Regulations and Conditions (continued)

5. The Centrex customer may choose to pay for the service on a month-to-month basis or under a service contract plan. A month-to-month Centrex customer may, at any time, convert to a service contract plan.
6. The monthly rate for customers choosing the service period plan is guaranteed against company initiated changes during the selected service contract period.
7. Subsequent line additions/deletions to the original service contract period will be treated as follows:
 - a. When a customer increases the number of Centrex lines, and the addition of lines causes the customer to qualify for a lower-rate tier, the customer shall be billed at the lower rates, as specified in B.1., for both the existing lines and the lines subsequently added.
 - b. Subsequent line deletions, resulting in reductions equal to or exceeding 20% of the initial quantity of lines under contract, will be considered a termination liability and treated as specified in C.8. below. Remaining lines will be billed at the tiered rates for the smaller line size group, as specified in B.1. above.
8. Termination Liabilities shall be treated as follows:
 - a. If the service is cancelled by the customer after installation of the service but prior to the completion of the service period, the customer shall be obligated to pay a termination liability charge. The charge is calculated by multiplying the monthly rate by the remaining months in the contract period times fifty percent (50%).
 - b. A customer who reduces the quantity of Centrex lines under contract has the following options for the duration of the contract period:



ISSUED: February 3, 1995

EFFECTIVE: February 7, 1995

Issued under the authority of the
Michigan Telecommunications Act, 1991 PA 179.

By: David A. Fox, General Manager

Westphalia, Michigan

LOCAL TELEPHONE EXCHANGE SERVICE

CENTREX SERVICE

C. Regulations and Conditions (continued)

- 1) Continue to pay an amount equal to the monthly rate for the number of Centrex station lines that are disconnected under contract, or;
 - 2) Pay termination charges as described in C.7. above on the number of Centrex stations lines disconnected.
9. At the Telephone Company's discretion, the non-recurring service establishment charges (per-system and per-line charges), as provided in paragraph B.1., may be reduced or waived during promotional campaigns and/or as a part of customer negotiations.
10. All exchange items in a Centrex group must have the same billing arrangement, either flat-rate or measured service (where offered).
11. When used with Call Forwarding or Call Transfer, the Centrex customer is responsible for the payment of the applicable toll charges for each billable call connected over the public network between the Centrex station and the station at which the call is answered. The charge is applicable to each call answered, including the Call Forwarding set-up call. It also applies to collect and person-to-person calls, which may be refused at the answering station.
12. Terminal equipment may be offered by the Telephone Company under contract or may be provided by the customer.
13. Unless specifically exempted, Centrex service shall be subject to all general regulations applicable to the provision of service by Westphalia Telephone Company in M.P.S.C. No. 1 tariff.



ISSUED: February 3, 1995

EFFECTIVE: February 7, 1995

Issued under the authority of the
Michigan Telecommunications Act, 1991 PA 179.

By: David A. Fox, General Manager

Westphalia, Michigan

Westphalia Telephone Company
M.P.S.C. No. 1R

Original Sheet No. 1

WESTPHALIA TELEPHONE COMPANY

Schedule of Rates, Charges, and
Regulations governing

Local Telephone Exchange Service

Applying in the Exchanges of this Company
in Michigan as designated in the Table of
Contents herein.



Issued: March 10, 1993
By: Dave Fox, Manager

Effective: March 22, 1993
Westphalia, Michigan